



SF-B023 Series

ANSI
ASME B18.3
ASTM F835~

STEEL HARDEN

Rockwell C37~

BLACK

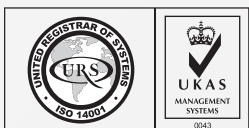

SOCKET BUTTON SCREW INCH (UNF THREAD)

STEEL GRADE BLACK C37~ RATED

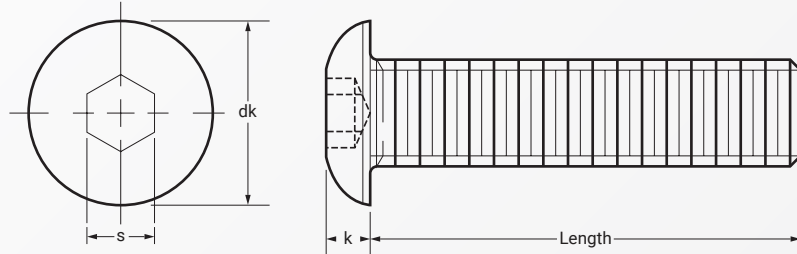

Dimension	threads per inch UNRF	dk	k	s	Length
#0	80	.114	.032	.035	From 1/8"
#1	72	.139	.039	.050	from 1/4"
#2	64	.164	.046	.050	from 1/16"
#3	56	.188	.052	.0625	from 1/8"
#4	48	.213	.059	.0625	from 1/8"
#5	44	.238	.066	.0781	from 3/16"
#6	40	.262	.073	.0781	from 1/8"
#8	36	.312	.087	.0937	from 1/8"
#10	32	.361	.101	.1250	from 3/16"
1/4	28	.437	.132	.1562	from 3/16"
5/16	24	.547	.166	.1875	from 1/4"
3/8	24	.656	.199	.2187	from 1/4"
1/2	20	.875	.265	.3125	from 1/2"
5/8	18	1.000	.331	.3750	from 3/4"

Above datas are for reference only

Note:

B023 denotes Steel harden with Rockwell C37~ hardness | UNF

Part number built example:

e.g. (1) Diameter #4-48 X 1" in steel harden black

» SF-B023 #4X1.0

e.g. (2) Diameter 3/8-24 X 2-1/2" in steel harden black

» SF-B023 3/8X2-1/2



sales@synergixfast.com



www.synergixfast.com



Phone: +65 6 316 2630 | Fax: +65 6 316 2730