



SF-B200 (UNC Series)  
SF-B202 (UNF Series)

ANSI  
ASME B18.3

STAINLESS STEEL 18-8

Rockwell B80~



RoHS Directive Compliance

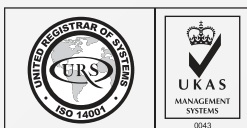

# SOCKET SET SCREW FLAT POINT INCH (UNC & UNF THREAD)

STAINLESS STEEL 18-8 Rockwell B80~ RATED

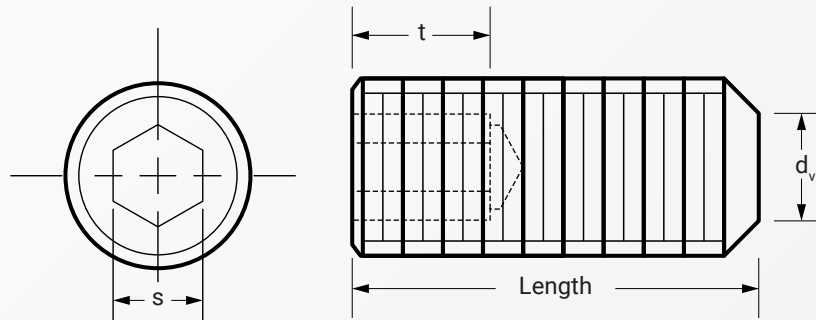

Dimension	threads per inch		s	d <sub>v max.</sub>	t	Length
	UNRC	UNRF				
#2	56	64	.035	.047	.035	from 3/32"
#3	48	56	.050	.054	.060	from 1/8"
#4	40	48	.050	.061	.075	from 1/8"
#6	40	40	.0625	.074	.075	from 3/16"
#8	32	36	.0781	.087	.075	from 1/8"
#10	24	32	.0937	.102	.105	from 3/16"
1/4	20	28	.125	.132	.105	from 1/4"
5/16	18	24	.1562	.172	.140	from 5/16"
3/8	16	24	.1875	.212	.140	from 1/4"
1/2	13	20	.250	.291	.210	from 3/8"

Above datas are for reference only

Note:

B200 denotes Stainless Steel 18-8 with Rockwell B80~ hardness | UNC Series  
B202 denotes Stainless Steel 18-8 with Rockwell B80~ hardness | UNF Series

Part number built example:

e.g. (1) Diameter 3/8-16 unc X 1/2" in stainless steel 18-8 >> SF-B200 3/8X1/2

e.g. (2) Diameter 3/8-24 unf X 1/2" in stainless steel 18-8 >> SF-B202 3/8X1/2



sales@synergixfast.com



www.synergixfast.com



Phone: +65 6 316 2630 | Fax: +65 6 316 2730