

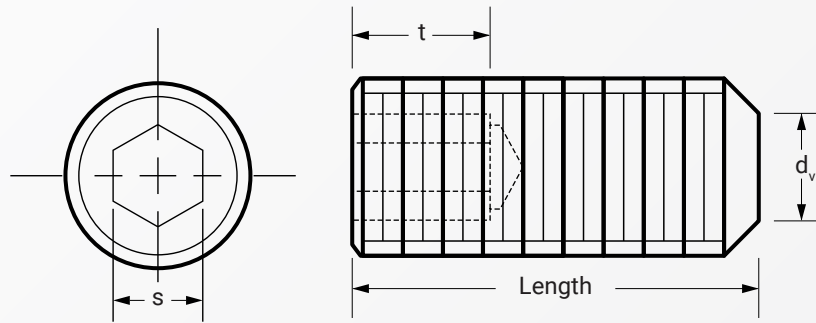

# SOCKET SET SCREW FLAT POINT INCH (UNC & UNF THREAD)

STAINLESS STEEL 316 Rockwell B80~ RATED



SF-B205 (UNC Series)  
SF-B207 (UNF Series)

ANSI  
ASME B18.3

STAINLESS STEEL 316

Rockwell B80~

Dimension	threads per inch		s	d <sub>v max.</sub>	t	Length
	UNRC	UNRF				
#2	56	64	.035	.047	.035	from 3/32"
#3	48	56	.050	.054	.060	from 1/8"
#4	40	48	.050	.061	.075	from 1/8"
#6	40	40	.0625	.074	.075	from 3/16"
#8	32	36	.0781	.087	.075	from 1/8"
#10	24	32	.0937	.102	.105	from 3/16"
1/4	20	28	.125	.132	.105	from 1/4"
5/16	18	24	.1562	.172	.140	special request
3/8	16	24	.1875	.212	.140	special request
1/2	13	20	.250	.291	.210	special request

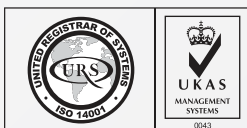

Above datas are for reference only

Note:

B205 denotes Stainless Steel 316 with Rockwell B80~ hardness | UNC Series  
B207 denotes Stainless Steel 316 with Rockwell B80~ hardness | UNF Series

Part number built example:

e.g. (1) Diameter #10-24 unc X 1/4" in stainless steel 316 >> SF-B205 #10X1/4  
e.g. (2) Diameter #10-32 unf X 1/4" in stainless steel 316 >> SF-B207 #10X1/4



sales@synergixfast.com



www.synergixfast.com



Phone: +65 6 316 2630 | Fax: +65 6 316 2730