



SOCKET SET SCREW CONE POINT INCH (UNC & UNF THREAD)

STAINLESS STEEL 316 Rockwell B80~ RATED

SF-B225 (UNC Series)
SF-B227 (UNF Series)

ANSI
ASME B18.3

STAINLESS STEEL 316

Rockwell B80~

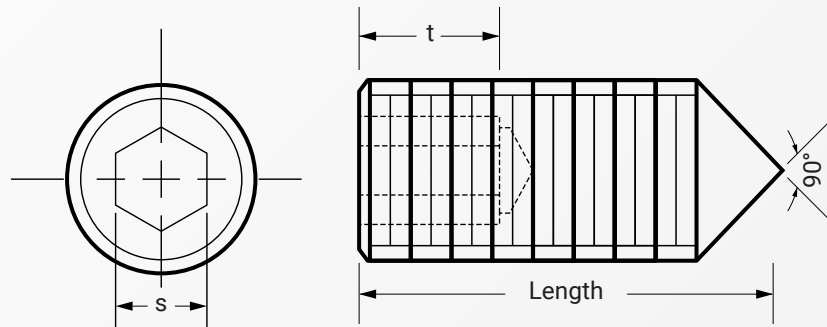

Dimension	threads per inch		s	t	Length
	UNRC	UNRF			
#2	56	64	.035	.035	from 1/8"
#4	40	48	.050	.075	from 1/8"
#5	40	44	.0625	.075	from 1/8"
#6	32	40	.0625	.075	from 3/16"
#8	32	36	.0781	.075	from 3/16"
#10	24	32	.0937	.105	from 3/16"
1/4	20	28	.125	.105	from 1/4"
5/16	18	24	.1562	.140	from 3/8"
3/8	16	24	.1875	.140	special request
1/2	13	20	.250	.210	special request

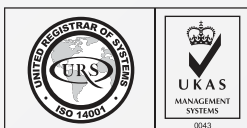

Above datas are for reference only
Angle maybe 90 degree / 120 degree, at mfr. preference

Note:
B225 denotes Stainless Steel 316 with Rockwell B80~ hardness | UNC Series
B227 denotes Stainless Steel 316 with Rockwell B80~ hardness | UNF Series

Part number built example:

e.g. (1) Diameter #10-24 unc X 1/4" in stainless steel 316 >>SF-B225 #10X1/4
e.g. (2) Diameter #10-32 unf X 1/4" in stainless steel 316 >>SF-B227 #10X1/4



sales@synergixfast.com



www.synergixfast.com



Phone: +65 6 316 2630 | Fax: +65 6 316 2730