

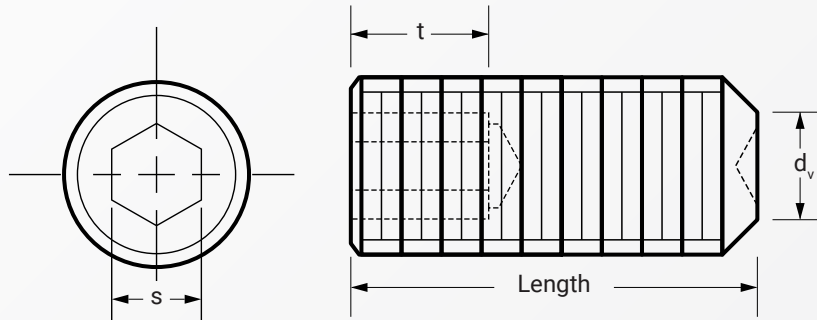

SOCKET SET SCREW CUP POINT INCH (UNC & UNF THREAD)

STAINLESS STEEL 18-8 Rockwell B80~ RATED



SF-B260 (UNC Series)
SF-B262 (UNF Series)

ANSI
ASME B18.3

STAINLESS STEEL 18-8

Rockwell B80~

| Dimension | threads per inch | | s | d _{v max.} | t | Length |
|-----------|------------------|------|-------|---------------------|------|-----------------|
| | UNRC | UNRF | | | | |
| #0 | - | 80 | .028 | .033 | .035 | from 1/16" |
| #1 | 64 | 72 | .035 | .040 | .035 | from 1/8" |
| #2 | 56 | 64 | .035 | .047 | .035 | from 1/16" |
| #3 | 48 | 56 | .050 | .054 | .060 | from 1/16" |
| #4 | 40 | 48 | .050 | .061 | .075 | from 1/16" |
| #5 | 40 | 44 | .0625 | .067 | .075 | from 3/32" |
| #6 | 32 | 40 | .0625 | .074 | .075 | from 3/32" |
| #8 | 32 | 36 | .0781 | .087 | .075 | from 3/32" |
| #10 | 24 | 32 | .0937 | .102 | .105 | from 1/8" |
| 1/4 | 20 | 28 | .125 | .132 | .105 | from 3/16" |
| 5/16 | 18 | 24 | .1562 | .172 | .140 | from 1/4" |
| 3/8 | 16 | 24 | .1875 | .212 | .140 | from 1/4" |
| 7/16 | 14 | 20 | .2187 | .252 | .190 | from 3/8" |
| 1/2 | 13 | 20 | .250 | .291 | .210 | from 1/4" |
| 9/16 | 12 | 18 | .250 | .332 | .265 | from 1/2" |
| 5/8 | 11 | 18 | .3125 | .371 | .265 | from 1/2" |
| 3/4 | 10 | 16 | .375 | .450 | .330 | from 1/2" |
| 7/8 | 9 | 14 | .500 | .530 | .450 | from 7/8" |
| 1 | 8 | 12 | .5625 | .609 | .550 | from 3/4" |
| 1 1/8 | 7 | 12 | .5625 | .689 | .650 | special request |
| 1 1/4 | 7 | 12 | .625 | .767 | .700 | special request |
| 1 3/8 | 6 | 12 | .625 | .848 | .700 | special request |
| 1 1/2 | 6 | 12 | .750 | .926 | .750 | special request |



RoHS Directive Compliance

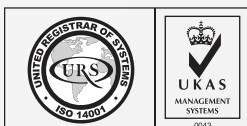

Above datas are for reference only
* denotes reference values

Note:

B260 denotes Stainless Steel 18-8 with Rockwell B80~ hardness | UNC Series
B262 denotes Stainless Steel 18-8 with Rockwell B80~ hardness | UNF Series

Part number built example:

e.g. (1) Diameter 1/4-20 unc X 1" in stainless steel 18-8 >> B260 1/4X1.0
e.g. (2) Diameter 1/4-28 unf X 1" in stainless steel 18-8 >> B262 1/4X1.0



sales@synergixfast.com



www.synergixfast.com



Phone: +65 6 316 2630 | Fax: +65 6 316 2730