

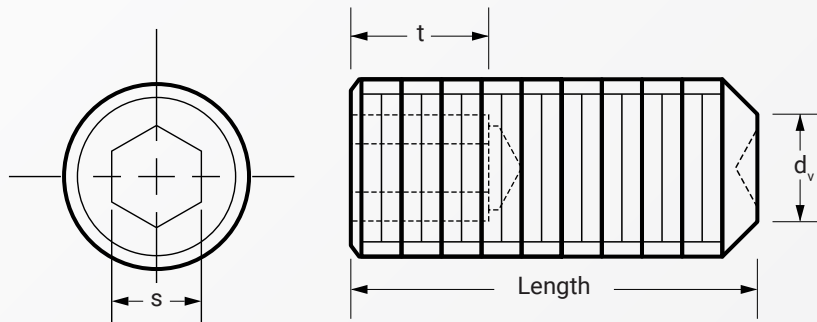

SOCKET SET SCREW CUP POINT INCH (UNC & UNF THREAD)

STAINLESS STEEL 316 Rockwell B80~ RATED



SF-B265 (UNC Series)
SF-B267 (UNF Series)

ANSI
ASME B18.3

STAINLESS STEEL 316

Rockwell B80~

Dimension	threads per inch		s	d _{v max.}	t	Length
	UNRC	UNRF				
#0	-	80	.028	.033	.035	from 1/16"
#1	64	72	.035	.040	.035	from 1/8"
#2	56	64	.035	.047	.035	from 1/16"
#3	48	56	.050	.054	.060	from 1/16"
#4	40	48	.050	.061	.075	from 1/16"
#5	40	44	.0625	.067	.075	from 3/32"
#6	32	40	.0625	.074	.075	from 3/32"
#8	32	36	.0781	.087	.075	from 3/32"
#10	24	32	.0937	.102	.105	from 1/8"
1/4	20	28	.125	.132	.105	from 3/16"
5/16	18	24	.1562	.172	.140	from 1/4"
3/8	16	24	.1875	.212	.140	from 1/4"
7/16	14	20	.2187	.252	.190	from 3/8"
1/2	13	20	.250	.291	.210	from 1/4"
9/16	12	18	.250	.332	.265	from 1/2"
5/8	11	18	.3125	.371	.265	from 1/2"
3/4	10	16	.375	.450	.330	from 1/2"
7/8	9	14	.500	.530	.450	from 7/8"
1	8	12	.5625	.609	.550	from 3/4"
1 1/8	7	12	.5625	.689	.650	special request
1 1/4	7	12	.625	.767	.700	special request
1 3/8	6	12	.625	.848	.700	special request
1 1/2	6	12	.750	.926	.750	special request



RoHS Directive Compliance

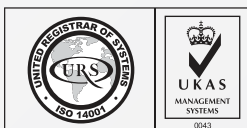

Above datas are for reference only
* denotes reference values

Note:

B265 denotes Stainless Steel 316 with Rockwell B80~ hardness | UNC Series
B267 denotes Stainless Steel 316 with Rockwell B80~ hardness | UNF Series

Part number built example:

e.g. (1) Diameter 5/16-18 unc X 3/4" in stainless steel 316 >> B265 5/16X3/4
e.g. (2) Diameter 5/16-24 unf X 3/4" in stainless steel 316 >> B267 5/16X3/4



sales@synergixfast.com



www.synergixfast.com



Phone: +65 6 316 2630 | Fax: +65 6 316 2730