



SF-F100 Series  
SF-F105 Series

ASME B18.2.2~

STAINLESS STEEL  
18-8 | 316

PLAIN

Other Finish Options:  
BLACK OXIDE  
PTFE COATED



RoHS Directive Compliance

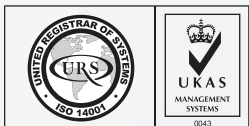

## HEXAGON NUT INCH (UNC THREAD) STAINLESS STEEL 18-8 | 316

PLAIN | BLACK OXIDE\* | PTFE COATED\*

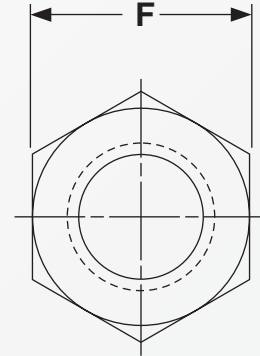
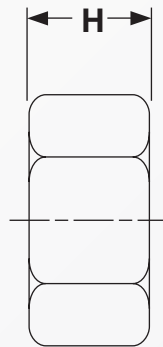

Dimension	Width (F)	Height (H)	Dimension	Width (F)	Height (H)
1-64	5/32"	3/64"	1/2"-13	3/4"	7/16"
2-56	3/16"	1/16"	9/16"-12	7/8"	31/64"
3-48	3/16"	1/16"	5/8"-11	15/16"	35/64"
4-40	1/4"	3/32"	3/4"-10	1 1/8"	41/64"
5-40	5/16"	7/64"	7/8"-9	1 5/16"	3/4"
6-32	5/16"	7/64"	1"-8	1 1/2"	55/64"
8-32	11/32"	1/8"	1 1/8"-7	1 11/16"	31/32"
10-24	3/8"	1/8"	1 1/4"-7	1 7/8"	1 1/16"
12-24	7/16"	5/32"	1 3/8"-6	2 1/16"	1 11/64"
1/4"-20	7/16"	7/32"	1 1/2"-6	2 1/4"	1 9/32"
5/16"-18	1/2"	17/64"	1 3/4"-5	2 5/8"	1 1/2"
3/8"-16	9/16"	21/64"	2"-4 1/2	3"	1 23/32"
7/16"-14	11/16"	3/8"			

Above datas are for reference only

Note:

F100 denotes unc hex nuts in stainless steel 18-8

F105 denotes unc hex nuts in stainless steel 316

Black oxide finish, have a dark surface color

PTFE coated, are chemical resistant & have a slippery surface to resist sticking during assembly

\*For optional finish, add "-BO" for black oxide | "-PTFE" for ptfе coating on part number

Part number built example:

e.g. (1) Diameter 5/8-11 in stainless steel 18-8

» SF-F100 5/8

e.g. (2) Diameter 5/8-11 in stainless steel 316

» SF-F105 5/8

e.g. (3) Diameter 1/4-20 in stainless steel 18-8 black oxide

» SF-F100 1/4-BO

e.g. (4) Diameter 1/4-20 in stainless steel 18-8 ptfе coated

» SF-F100 1/4-PTFE



sales@synergixfast.com



www.synergixfast.com



Phone: +65 6 316 2630 | Fax: +65 6 316 2730