



SF-A023 SERIES

ISO 4028
DIN 915~
JIS B 1177

STEEL

45H

BLACK

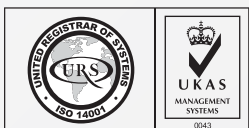

SOCKET SET SCREW DOG POINT

STEEL 45H BLACK

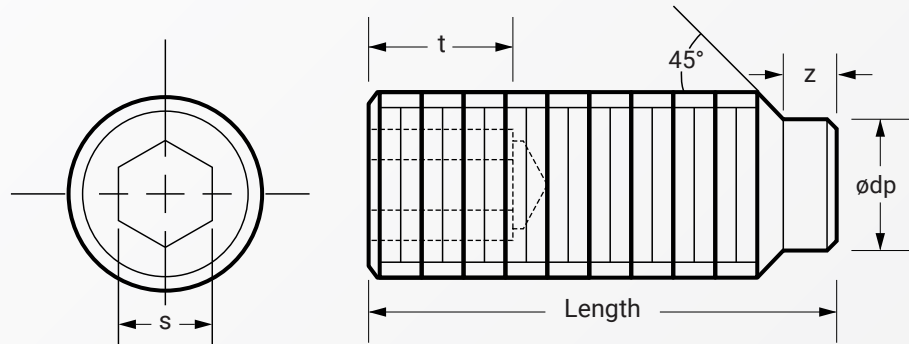

Dimension	s	Z ₁ max. (short)	t ₁	d _p	Z ₂ max. (long)	t ₂	Length
M 1.4*	0.7	0.65	0.6	0.7	1.05	1.4	special request
M 2*	0.9	0.75	0.8	1	1.25	1.7	from 6mm
M 3	1.5	1	1.2	2	1.75	2	from 4mm
M 4	2	1.25	1.5	2.5	2.25	2.5	from 5mm
M 5	2.5	1.5	2	3.5	2.75	3	from 5mm
M 6	3	1.75	2	4	3.25	3.5	from 6mm
M 8	4	2.25	3	5.5	4.3	5	from 8mm
M 10	5	2.75	4	7	5.3	6	from 10mm
M 12	6	3.25	4.8	8.5	6.3	8	from 16mm
M 14	6	3.8	5.6	10	7.36	9	special request
M 16	8	4.3	6.4	12	8.36	10	from 16mm
M 20	10	5.3	8	15	10.36	12	from 20mm
M 24	12	6.3	10	18	12.43	15	special request

Above datas are for reference only
* denotes reference values to DIN 915

z₁ max. (short) & t₁ = length above dashed step line
z₂ max. (long) & t₂ = length below dashed step line

Note:
A023 denotes steel in 45H material black

Part number built example:

e.g. (1) Diameter M8X20 in 45H steel black >> SF-A023 8X20
e.g. (2) Diameter M4X16 in 45H steel black >> SF-A023 4X16



sales@synergixfast.com



www.synergixfast.com



Phone: +65 6 316 2630 | Fax: +65 6 316 2730