



## SF-E070 SERIES

DIN 934~ (Ref.)

STEEL

CLASS 6

ZINC PLATE



RoHS Directive Compliance

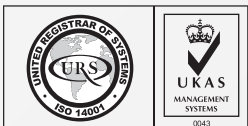
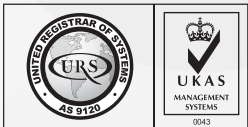

# HEXAGON LOCK NUT W/STAR WASHER (KEPS)

STEEL CLASS 6 | ZINC

BOTTOM VIEW

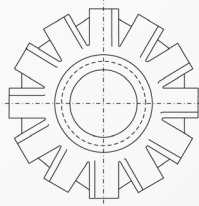

SIDE VIEW

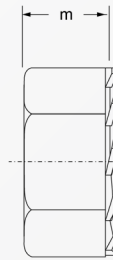

TOP VIEW

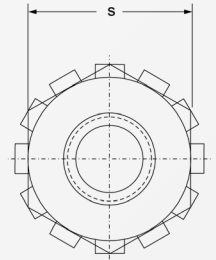

Dimensions	m (ref.)	s (ref.)
M 3	2.4	5.5
M 4	3.2	7
M 5	4.7	8
M 6	5.2	10

Above datas are for reference only

Note:  
E070 denotes steel class 6 zinc

Part number built example:

e.g. (1) Diameter M5 in steel class 6 material

»SF-E070 M5



sales@synergixfast.com



www.synergixfast.com



Phone: +65 6 316 2630 | Fax: +65 6 316 2730