



SF-E152 SERIES

DIN 985
ISO 10511

STAINLESS
STEEL

A4-80

PASSIVATED

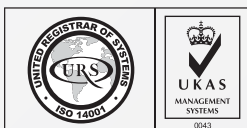

HEXAGON LOCK NUT WITH NYLON INSERT (THIN TYPE)

STAINLESS STEEL A4-80

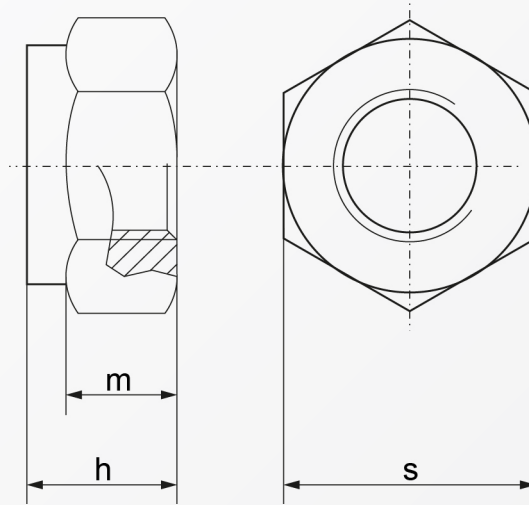

Dimensions	$h_{\text{max. ISO/DIN}}$	$m_{\text{min. ISO/DIN}}$	$s_{\text{ISO/DIN}}$
M 2.5*	3,6	-	5
M 3	3.9/4	1.55/2.4	5.5
M 4	5	1.9/2.9	7
M 5	5	2.5/3.2	8
M 6	6	2.9/4	10
M 7	7.5	4.7	11
M 8	6.8/8	3.7/5.5	13
M 10	5,6/10	4.7/6.5	16/17
M 12	10.2/12	5.7/8	18/19
M 14	11.3/14	6.4/9.5	21/22
M 16	12,4/16	7.4/10.5	24
M 18**	18.5	13	27
M 20	14.9/20	9.1/14	30
M 22**	22	15	34/32
M 24	17.8/24	10.9/15	36
M 27**	27	17	41
M 30	22.2/30	13.9/19	46
M 33**	33	22	50
M 36	25.5/36	16.9/25	55
M 39**	39	27	60
M 42**	42	29	65
M 45**	45	32	70
M 48**	48	36	75

Above datas are for reference only
* & ** dimensions not listed in ISO standard
For use at temperature -50 to +120 degree
Limited dimension options for A4-80 grade

Note:
E152 denotes stainless steel A4-80 grade

Part number built example:
e.g. (1) Diameter M12 in stainless steel A4-80 grade

»SF-E152 M12



sales@synergixfast.com



www.synergixfast.com



Phone: +65 6 316 2630 | Fax: +65 6 316 2730