



SF-G010P2 SERIES  
SF-G100P2 SERIES

JIS B 1111 (Ref.)

STEEL 4.8

ZINC PLATED

STAINLESS A2

PASSIVATED



RoHS Directive Compliance

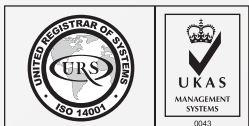
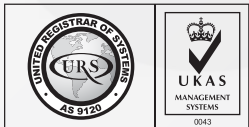

## SEMS PHILIP MACHINE SCREW P2 (WITH SPRING WASHER)

STEEL 4.8 | ZINC PLATED  
STAINLESS A2 | PASSIVATED

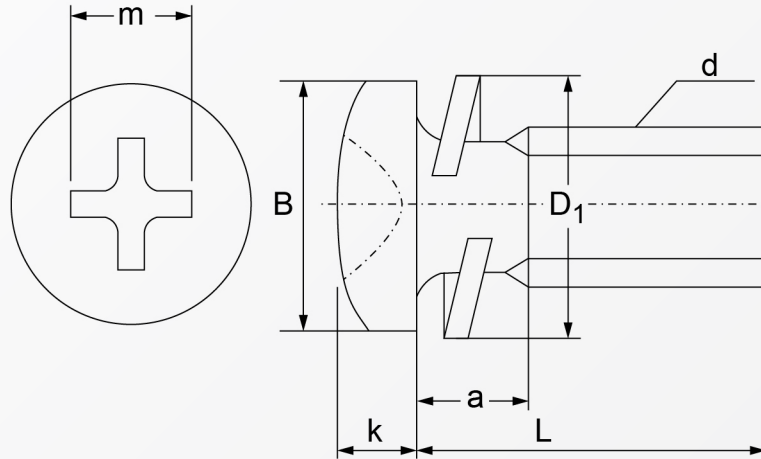

Diameter of Screw			M3	M4	M5	M6
Pan Head	B	Standard dimensions	5.5	7	9	10.5
		tolerance	0 /- 0.5	0 /- 0.5	0 /- 0.6	0 /- 0.7
	k	Standard dimensions	2	2.6	3.3	3.9
		tolerance	±0.15			±0.20
Cross recess number		2		3		
Spring washer (2)	D1 (maximum)		5.5	7	8.5	11.5
	Width x Thickness		1.1 x 0.7	1.4 x 1.0	1.7 x 1.3	2.7 x 1.5
From the washer to the complete threaded portion (a) maximum			2.4	3.5	4.3	5.1
Length			from 6mm	from 8mm	from 10mm	from 12mm

Above datas are for reference only

Part number built example:

e.g. (1) Select Diameter M4X15 in steel material >> SF-G010P2 4X15  
e.g. (2) Select Diameter M6X20 in stainless steel A2 material >> SF-G100P2 6X20



sales@synergixfast.com



www.synergixfast.com



Phone: +65 6 316 2630 | Fax: +65 6 316 2730