



SF-G010P4 SERIES
SF-G100P4 SERIES

JIS B 1111 (Ref.)

STEEL 4.8

ZINC PLATED

STAINLESS A2

PASSIVATED



SEMS PHILIP MACHINE SCREW P4 (WITH SMALL FLAT & SPRING WASHER)

STEEL 4.8 | ZINC PLATED
STAINLESS A2 | PASSIVATED

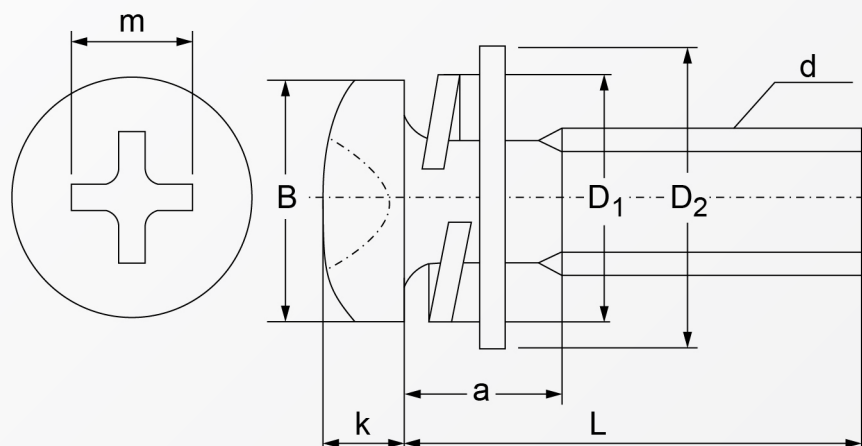

Screw nominal (Ø d)			M3	M4	M5	M6
Pan Head	B	Standard dimensions	5.5	7	9	10.5
		tolerance	0 / -0.5	0 / -0.5	0 / -0.6	0 / -0.7
	k	Standard dimensions	2	2.6	3.3	3.9
		tolerance	±0.15			±0.20
	Cross recess number		2			3
Small round flat washer	D2 (maximum)	Standard dimensions	6	8	10	11.5
		tolerance	0 / -0.3	0 / -0.35		0 / -0.4
	Thickness	Standard dimensions	0.5		0.8	
Spring washer (2)	D1		5.5	7	8.5	11.5
	Width x Thickness		1.1 x 0.7	1.4 x 1.0	1.7 x 1.3	2.7 x 1.5
From the washer to the complete threaded portion (a) maximum			3	4.4	5.4	6.9

Above datas are for reference only

Part number built example:

e.g. (1) Select Diameter M4X12 in steel material » SF-G010P4 4X12
e.g. (2) Select Diameter M5X16 in stainless steel A2 material » SF-G100P4 5X16



sales@synergixfast.com



www.synergixfast.com



Phone: +65 6 316 2630 | Fax: +65 6 316 2730