



**SF-G080 SERIES**  
**SF-G082 SERIES**

DIN 7337B~ (Ref.)

STEEL | STEEL  
ALUMINIUM | STEEL

ZINC



RoHS Directive Compliance

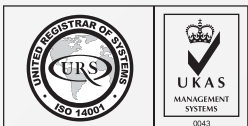
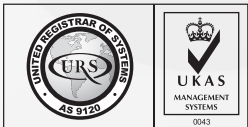

# BLIND RIVETS CSK OPEN END (PROTRUDING HEAD)

ST/ST & ALU/ST (ZINC)

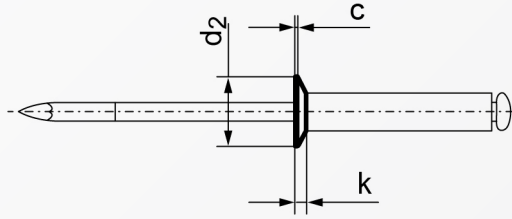

Nominal Ø	3	4	5
d2	6.0	7.5	9.0
k	0.9	1.0	1.2
c	0.3	0.3	0.4
drill Ø	3.1	4.1	5.1
Length	Clamping length range (min. - max.)		
4 St./Al.	-/1.0 - 1.5	-	-
6 St./Al.	1.0 - 3.0/1.5 - 3.5	1.0 - 2.5/1.5 - 3.0	1.0 - 2.0/-
8 St./Al.	3.0 - 5.0/3.5 - 5.0	2.5 - 4.5/3.0 - 5.0	2.0 - 4.0/2.0 - 4.5
10 St./Al.	5.0 - 6.5/5.0 - 7.0	4.5 - 6.5/5.0 - 6.5	4.0 - 6.0/4.5 - 6.0
12 St./Al.	6.5 - 8.5/7.0 - 9.0	6.5 - 8.5/6.5 - 8.5	6.0 - 8.0/6.0 - 8.0
14 St./Al.	-	-	8.0 - 9.5/-
16 St./Al.	-/9.0 - 13.0	8.5 - 12.0/8.5 - 12.5	
18 St./Al.	-	-/12.5 - 14.5	
20 St./Al.	-	12.0 - 16.0/14.5 - 16.5	
25 St./Al.	-	-	

Above datas are for reference only  
Mandrel & stem, same matching material

Note:  
G080 denotes steel/steel zinc & G082 denotes aluminium/steel zinc

Part number built example:  
e.g. (1) Diameter M3.2 X 12 in ST/ST ZB material >> SF-G080 3.2X12  
e.g. (2) Diameter M4 X 16 in ALU/ST ZB material >> SF-G082 4X16



sales@synergixfast.com



www.synergixfast.com



Phone: +65 6 316 2630 | Fax: +65 6 316 2730