



## SF-M070 SERIES

DIN 7344  
ISO 8748

STEEL BLACK



RoHS Directive Compliance

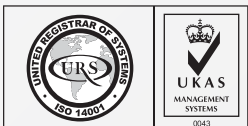
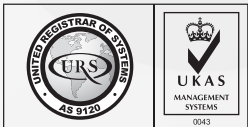

# SPRING TYPE STRAIGHT PINS COILED (HEAVY TYPE)

STEEL BLACK

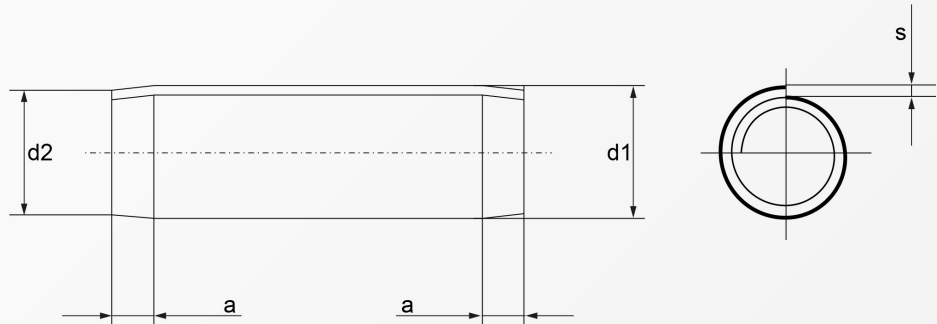

Dimensions	a	s	d1 <sup>1</sup>	d2 <sup>1</sup>	shear strength <sup>2</sup>
1.5	0.5	0.17	1.6	1.4	1.9
2	0.7	0.22	2.1	1.9	3.5
2.5	0.8	0.28	2.6	2.35	5.5
3	1	0.33	3.12	2.85	7.6
4	1.3	0.45	4.15	3.8	13.5
5	1.7	0.56	5.15	4.8	20
6	2	0.67	6.25	5.8	30
8*	2	0.9	8.25	7.8	53

Above datas are for reference only  
 \*dimensions not listed in standard  
 1 dimension before installation  
 2 shear strength, double kN, only for spring steel

Part number built example:

e.g. (1) Select Diameter 4X30 in steel material >>SF-M070 4X30



sales@synergixfast.com



www.synergixfast.com



Phone: +65 6 316 2630 | Fax: +65 6 316 2730