



SF-M090 SERIES
SF-M190 SERIES

DIN 6885A

STEEL

STAINLESS STEEL
A4



RoHS Directive Compliance



PARALLEL KEYS TYPE A

STEEL | STAINLESS STEEL A4

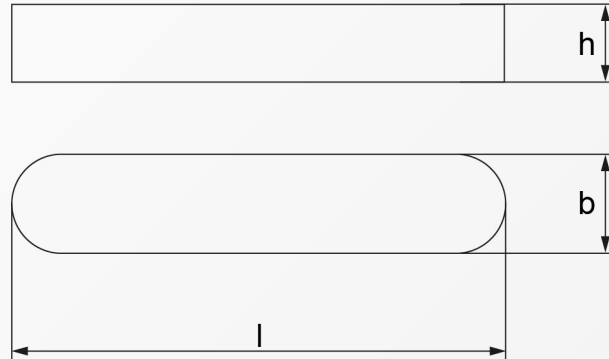

Dimension	h	for shafts $\varnothing d/d_1$	Length
2	2	6 - 8	from 8mm
3	3	8 - 10	from 8mm
4	4	10 - 12	from 8mm
5	5	12 - 17	from 10mm
6	6	17 - 22	from 10mm
8	8	22 - 30	from 16mm
10	10	30 - 38	from 20mm
12	12	38 - 44	from 20mm
14	14	44 - 50	from 28mm
16	16	50 - 58	from 36mm
18	18	58 - 65	from 36mm
20	20	65 - 75	from 50mm
22	22	75 - 85	from 50mm
25	25	85 - 95	from 70mm
28	28	95 - 110	from 80mm
32	32	110 - 130	from 70mm
36	36	130 - 150	from 100mm
40	40	150 - 170	from 140mm
45	45	170 - 200	from 200mm

Above datas are for reference only
type A = round-ended without holes
b = nominal size

Part number built example:

e.g. (1) Select Diameter 3X3X12 in steel material

»SF-M090 3X3X12

e.g. (2) Select Diameter 5X5X25 in stainless steel A4 material

»SF-M190 5X5X25



sales@synergixfast.com



www.synergixfast.com



Phone: +65 6 316 2630 | Fax: +65 6 316 2730